

Description

Mechanical Connector Premium KeyQuick® 20 SC APC SM 9/125 universal for flat and round cable 2,0mm and 3,0mm | **KQ20SCA**

Mechanical Connector Premium KeyQuick® 20 SC UPC SM 9/125 universal for flat and round cable 2,0mm and 3,0mm | **KQ20SC**

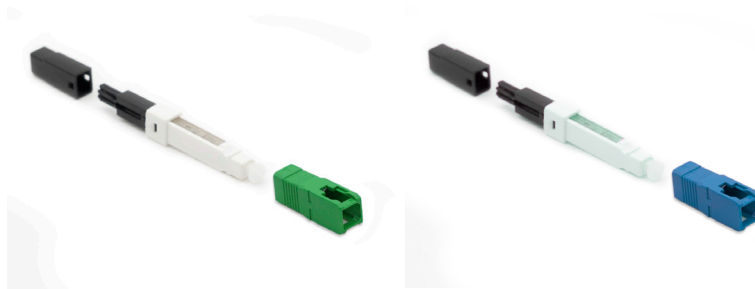

In recent years the data communication capabilities supporting the Enterprise and Data Center markets have been expanding at breakneck speed. Fibre Optic Connector SC are commonly used in fibre optic backbone and horizontal application to provide high-speed data transmission.

One of the most important consideration of KeyQuick® 20 is the excellent performance, and the easy to be assembled at the installation site by workers. Without the need of tools, our connector is accessible to be assembled by everyone without any special skill sets.

The transparent body enables immediate splice verification by our Visual Fault Locator. The splicing method is as simple as aligning the V-groove and sliding to tie-up the fibre. The "Sliding and V-groove Tie-up" splicing method is possible to clamp fibre and coated fibre with just a single part number.

The qualification tests results ensure the quality of our products subjected to severe mechanical and environmental conditions.

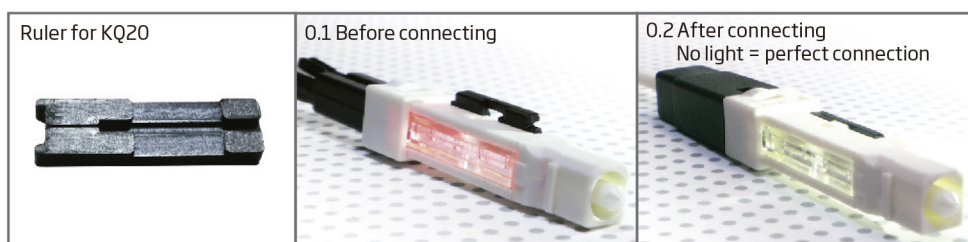

Application

- FTTx System.
- LAN, WAN and Metro Networks.
- Data Centers.
- Networking Monitoring.
- Telecommunication.



Features

- Pre-polished connector
- No Epoxy required
- No Tool or jig required
- Transparent body for immediate splice verification
- 30 seconds for connecting
- Mean Insertion Loss: 0.2 dB
- Releasable after connecting
- Easy-to-install device
- UL 94-V0. KeyQuick® 20 can pass the Underriters Laboratory (UL) Standard 94 Flammability Test

Specifications

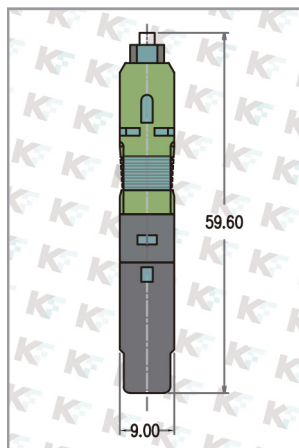

Cable size	FTTH Indoor and Hard Drop Cable
Assembly time	30 secons (after fibre preparation)
Insertion loss, typical	0.2 dB (APC)
Return loss	-53 dB Typical (APC)
Pull Strength (N)	Flat Cable Type: 70N
IP protection level	5N
Operating Temperature (°C)	-40~+75
Materials	Engineering plastics & index matching gel (IMG)

Assembly procedure

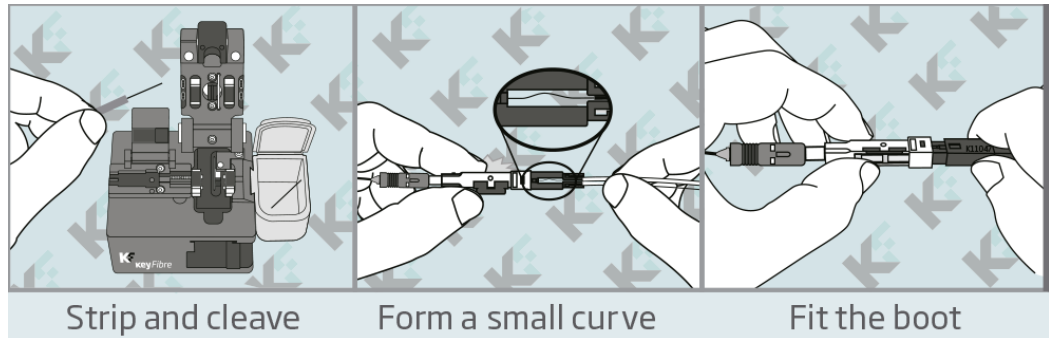

Benefits

KeyQuick®20 SC Field Installable Connector specific for at cable, enables easy strip and fast Indoor/Outdoor/Low Friction, Flat FTTH Drop cable termination in the field.

Even more easy

Easy strip method, excellent crush resistance and tensile strength of this cable combined with the excellent pull strength results.

Avoid installer mistakes. Save time

The most common "first time installer errors" when installing a field installable connector are cleave quality, cleave length and stripping. By using KeyCleave® ruler, with KeyQuick® system, these three aspects are controlled.

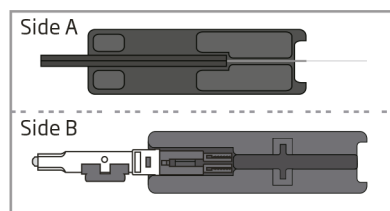

Workability and Accuracy

We have made every kind of improvement to the field installable connectors throughout our manufacturing and development process aiming at excellent workability and accuracy in the fibre and connector installation. In this concept, we considered that the following conditions are required in order to realize the stable assembly success rate and good workability of connectors.

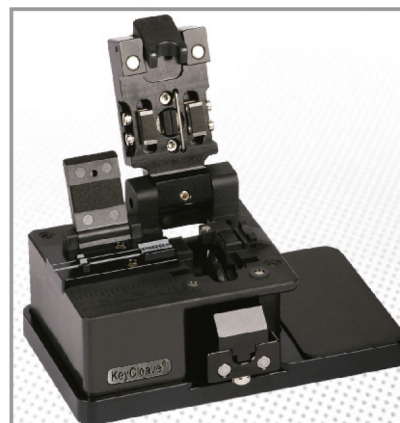

Except an stripper and Cleaver.

An installer can work without additional equipment, except a stripper and a cleaver which are also common used for traditional fusion methods. We have created an skill-free design to open the market to everybody to install fibre. Reduce the number of parts in order to reduce working time.

The less re-work, the less expensive

Visual verification if the connection is good or not without using a power meter.



Installers can have immediately verification result of their job because KeyQuick® external structure of the connector is totally transparent. The Unique mechanical system that can guarantee 100% good results, no light means perfect connection. Leave the work well done, first time, that's the objective.

Reusable technology

Fibre insertion can be done several times without affecting the performance of the connector.

Fibre length, the success

Fibre length is very important in success of connector installation, and one of the "most common errors of first-time-installers". Fibre length confirmation ruler is equipped with our KeyCleave® Fiber Cleaver, to assure the optical performance .

KeyQuick® Transparent Body Concept

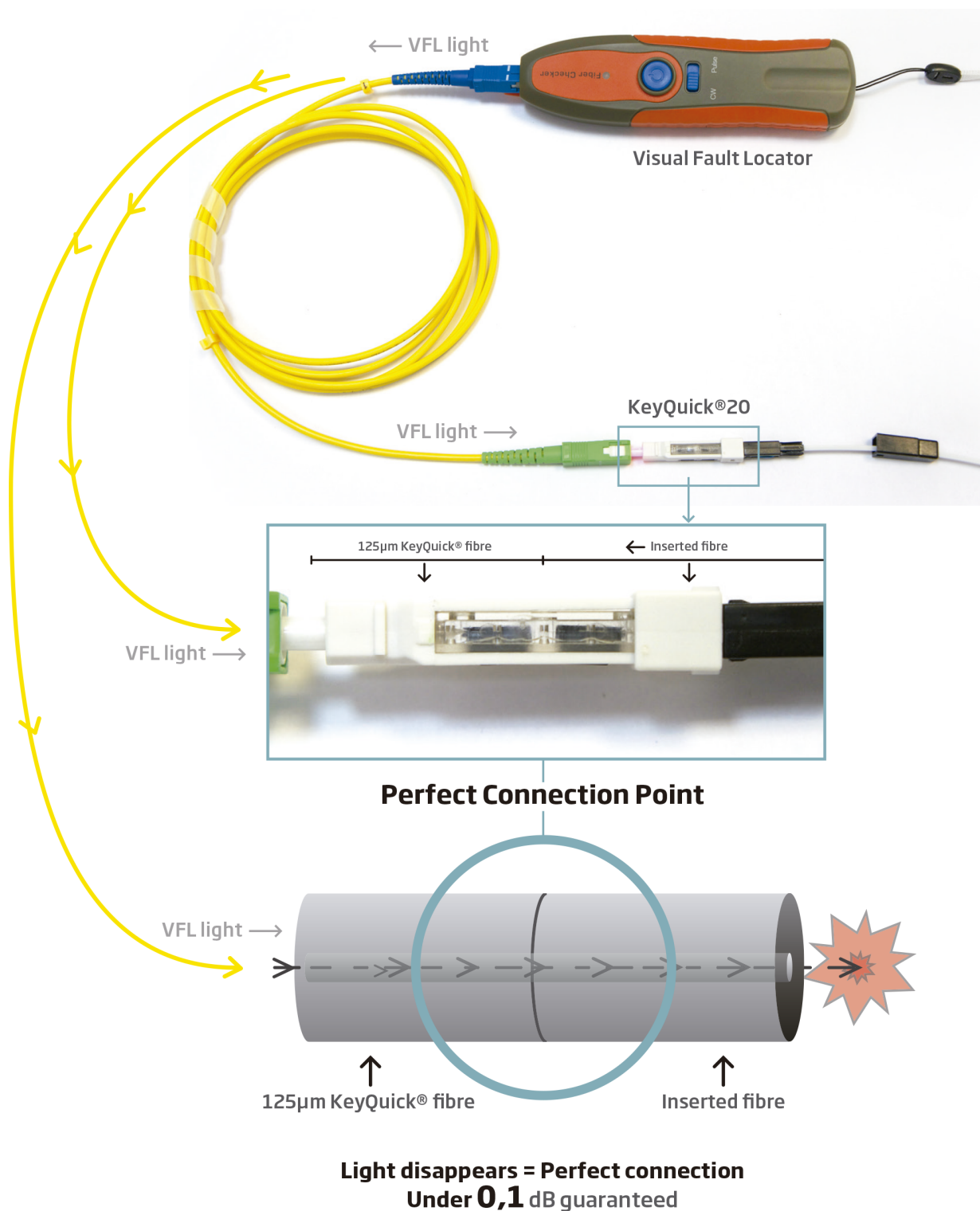

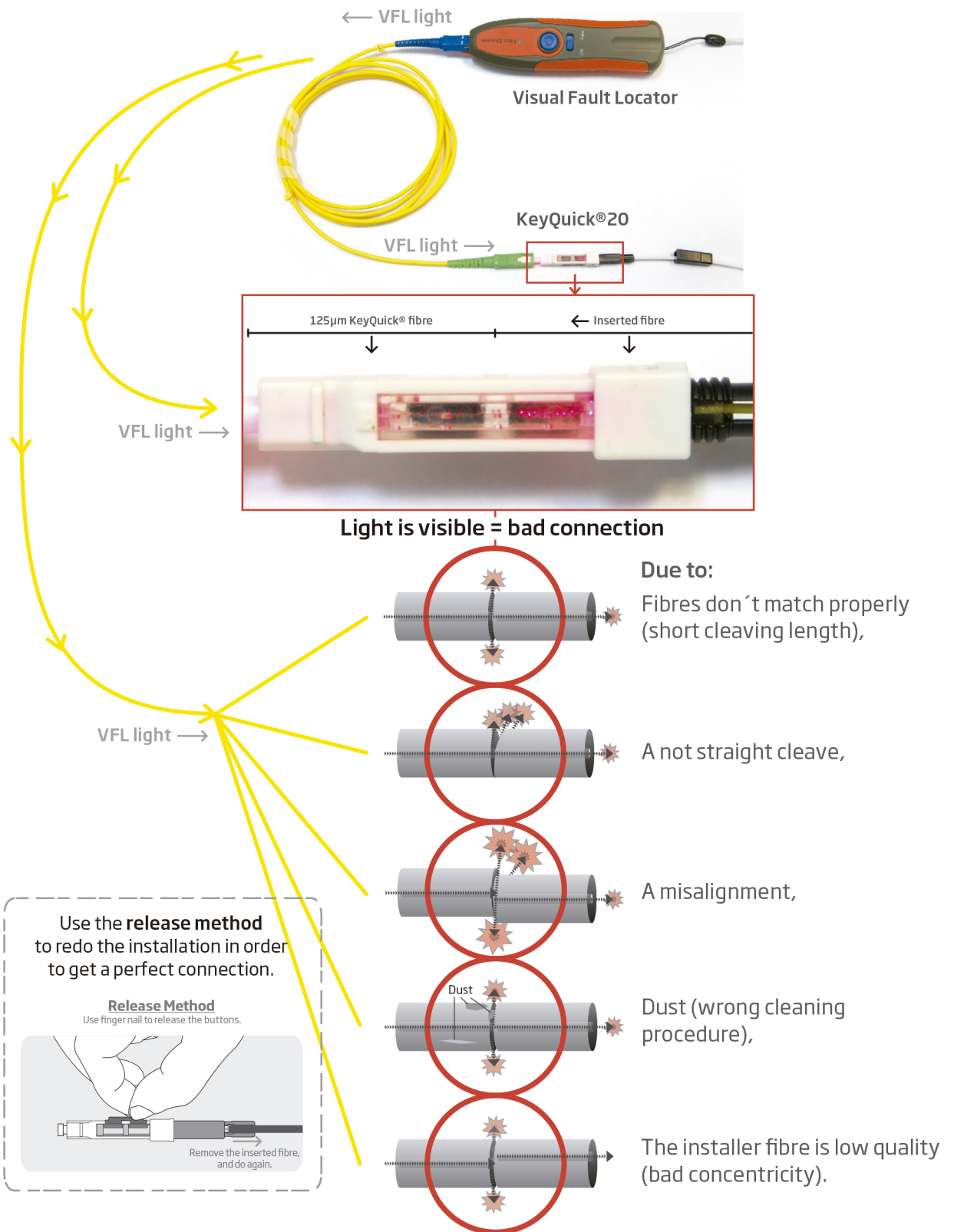

DATA SHEET

KeyQuick® mechanical connector

Doc. Ref.: FT-EN-V1-KF-KQ20SCA-KQ20SC

Date: 24/05/2024

Packagind details

P/N	Housing color	Boot color	Pieces Carton	per	Carton size (cm)	Carton (Kg)	Weight
KQ20-SCA	Green	Black	25		17,5 x 12,5 x 4,5	0,20	
KQ20-SC	Blue	Black	25		17,5 x 12,5 x 4,5	0,20	

Related products



Microscope



Cleaner

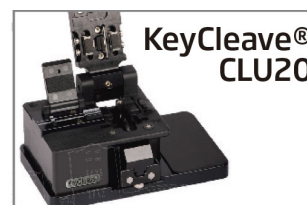

KeyCleave®
CLU20



KTKB



Visual Fault Locator

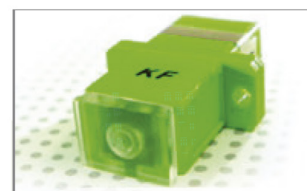

SC/APCAdapter Transpa-
rent Dust Cap



keyFibre

KEYQUICK® CONNECTIVITY

PAGE 7 OF 7

KEYFIBRE NETWORK COMPONENTS, S.L. | keyfibre.com | info@keyfibre.com | Tel.: +34 96 277 94 26 | Calle Sequia del Quint, 48. Pol. Ind. Entrevies. 46190 Ribarroja de Turia (Valencia) Spain